

IMPORTANT SAFETY INSTRUCTIONS

WARNING

To reduce the risk of injury or death to persons

- 1) **READ AND FOLLOW ALL INSTRUCTIONS**
- 2) Disconnect power supply before attempting installation
- 3) For use with a Class 2 supply +6V DC to +40V DC
- 4) For use as entrapment protection device on doors or gates
- 5) Refer to door or gate operator manual for details of accurate connection to the operator
- 6) OPTOEYE photo eyes are to be placed at the bottom of the opening no more than 6 inches (doors)/ 27.5 inches (gates) from the ground
- 7) OPTOEDGE safety edges are to be placed where risk of entrapment or obstruction exists, such as the bottom edge of a vertically closing edge
- 8) **SAVE THESE INSTRUCTIONS**

Description

The OPTOEDGE and OPTOEYE are entrapment protection devices to safeguard doors or gates acc. to the requirements of UL325. The same optical sensors are used for both systems: for the photo eye OPTOEYE and the sensing edge OPTOEDGE.

Technical Data

Power Consumption	max. 50 mA
Supply Voltage	6 to 40V DC
Operation Temp. Range:	-13°F to 165°F
Safety Edge	30 ft.
Photo Eye	45 ft.

VITECTOR

FRABA

INSTALLATION INSTRUCTION

1. Measure required length of safety edge and cut rubber. Leave about 1 inch space for each bumper on both sides of the door.

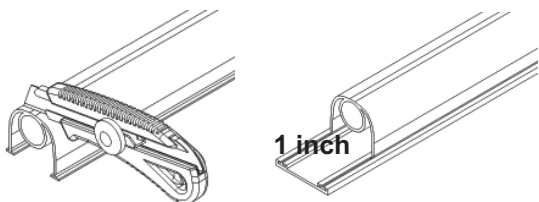

2. Pull rubber extrusion into retainer
3. Plug sensors into rubber adapter sleeves and push them into the circular rubber chamber of the extrusion

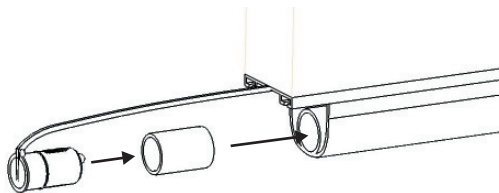

4. Install the junction box with included bend protection on the side of the door, closest to the operator. Mount 2nd junction box on opposite side.
5. Wire sensor cables through rubber extrusion into the junction boxes

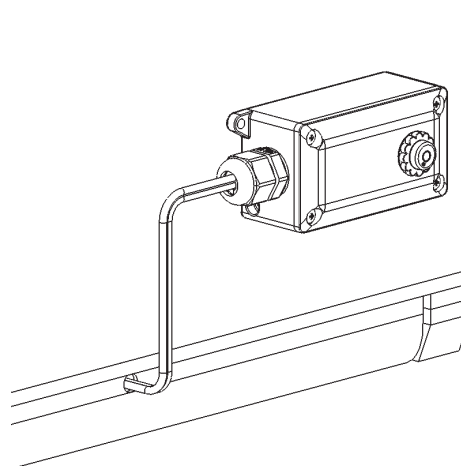

6. Use included 30 ft. cable to interconnect the junction boxes on both sides of the door

Final Assembly

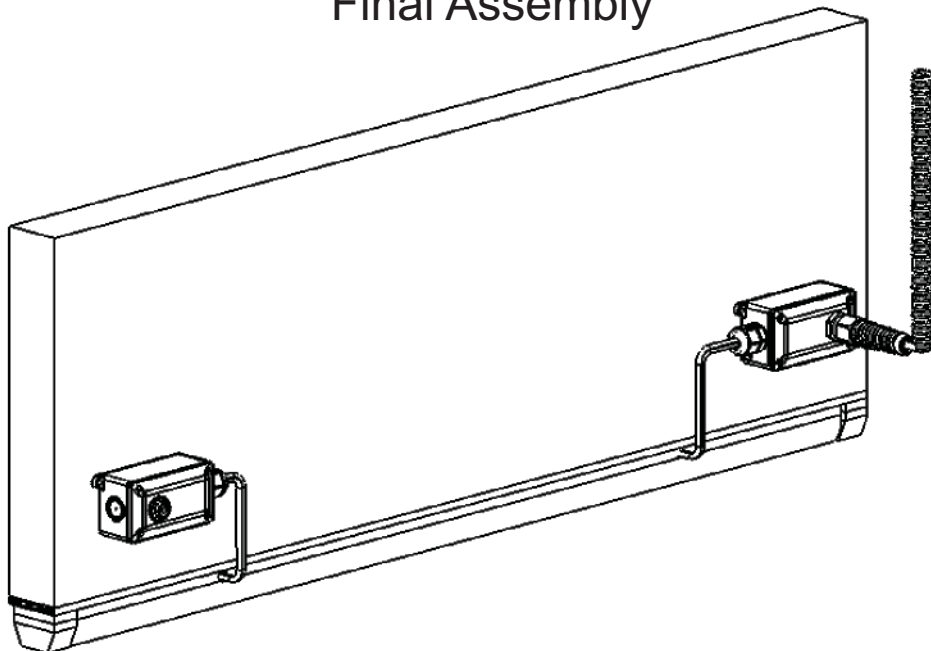

FRABA Inc.
1800 E State Street, Suite 148, Hamilton NJ 08609
Phone 1-609-750-8705, Fax 1-609-750-8703
www.vitector.com, info@vitector.com

VITECTOR

FRABA

INSTALLATION INSTRUCTION

7. Mount plastic bumpers on both sides of the safety edge. Use included sheet metal screws for installation to the door section.

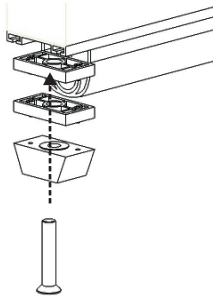

8. Wire the short end of the coil cord through the bend protection into the junction box. Connect it to the sensor cable.

9. Use included steel mounting bracket to install the long end of the coil cord at the halfway point of the door height.

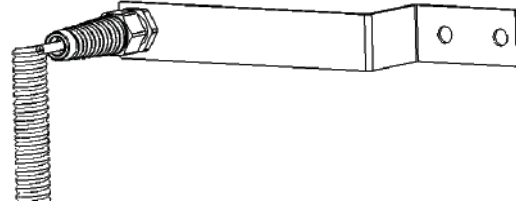

10. Connect coil cord to the dynamic 2-wire interface of the operator. Do NOT connect to the Normally Open Contact.

Wiring Diagram

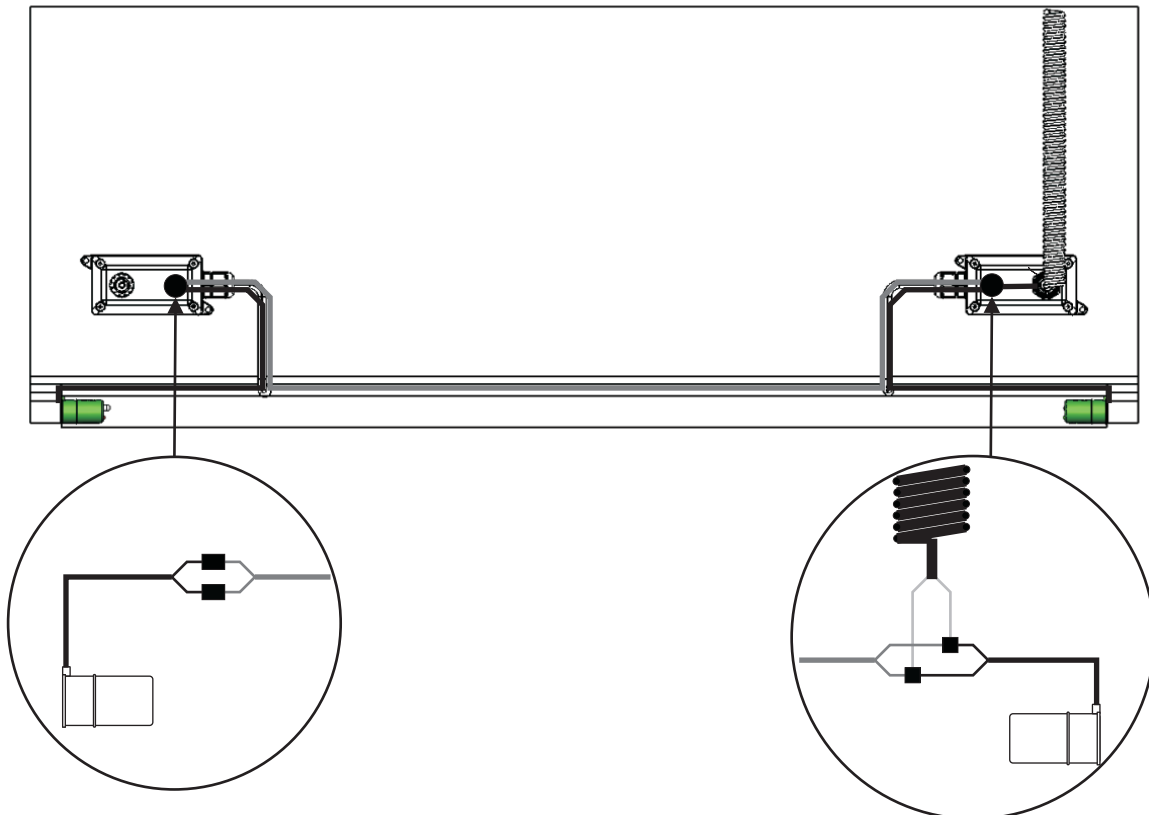

FRABA Inc.
1800 E State Street, Suite 148, Hamilton NJ 08609
Phone 1-609-750-8705, Fax 1-609-750-8703
www.vitector.com, info@vitector.com

INSTALLATION DOORS AND GATES

Doors and Gates must be equipped with entrapment protection devices to avoid danger of injury to persons. Before installation of such devices, the installer has to identify all danger zones of the door or gate.

Doors

Install non-contact sensor in the door opening not higher than 6 in. from the ground

OR

Install contact sensors on the leading edge of the door

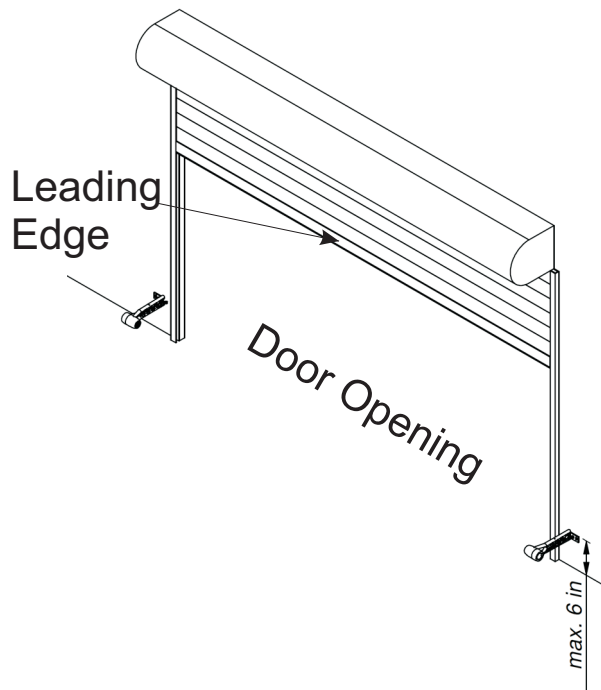

Gates

Install non-contact sensor in the gate opening not higher than 27 1/2 in. from the ground

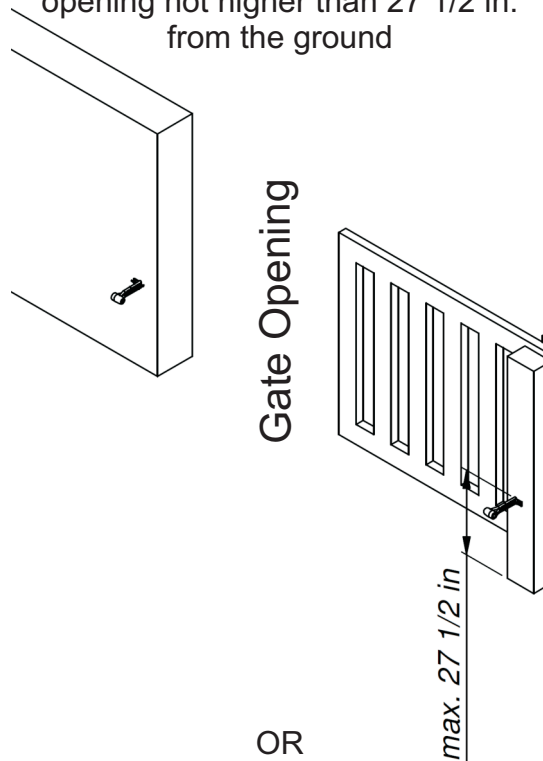

Install contact sensors on the leading edge of the gate and all other identified pinch-points

